

1720 - 1748 N. Greenville Avenue

Richardson, Texas 75081

www.momentumreal.com

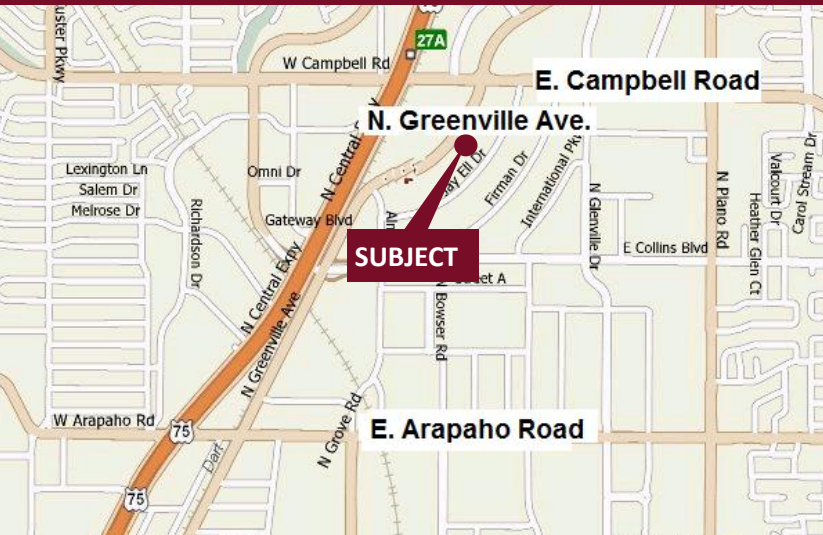

Available for Lease

±28,209 SF OFFICE/SHOWROOM

Building Features:

- Lease Space From 1,050 S.F.
- 100% AC
- Highly Visible and Well Traveled Location
- Clear Height 14'
- 122 Concrete Parking Spaces
- Rear Loading with Semi-Dock High or Grade Level Roll Up Doors

For more information or to schedule a tour, please contact:

Daniel Greenberg

Vice President

972.707.9155 Direct

214.536.2735 Cell

dgreenberg@momentumreal.com

Jessica Reinhardt

Vice President - Leasing

972.707.9156 Direct

972.891.5236 Cell

jreinhardt@momentumreal.com



16610 Dallas Parkway, Suite 2300

Dallas, Texas 75248

Office 972.707.9150

leasing@momentumreal.com

1720 - 1748 N. Greenville Avenue

Richardson, Texas 75081

www.momentumreal.com

Site Map

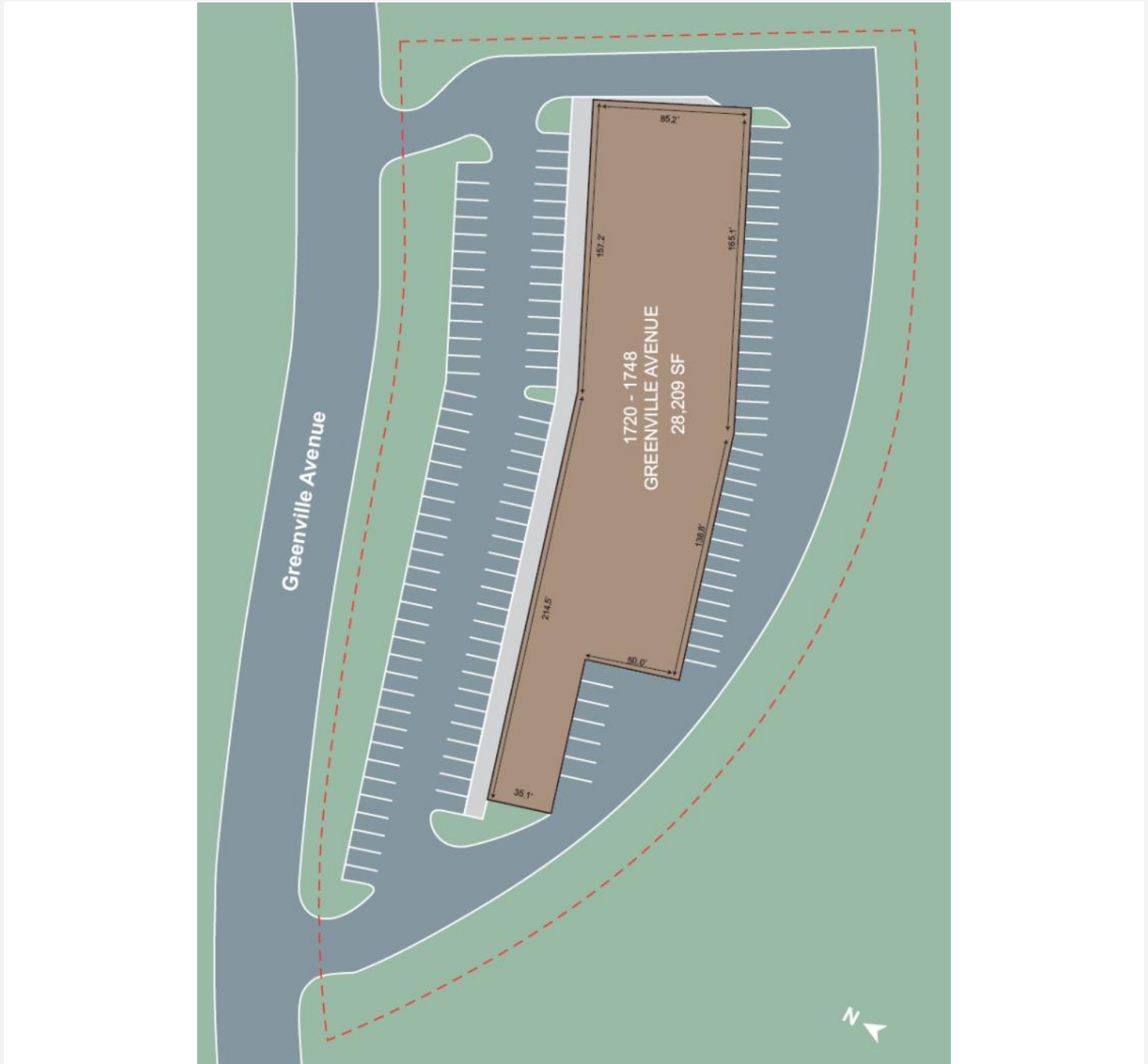

16610 Dallas Parkway, Suite 2300

Dallas, Texas 75248

Office 972.707.9150

leasing@momentumreal.com